



Polished Nickel (Finish ID : 8)

BEAULIEU CUP PULL

“Form and function complemented by a clean and defined stepped edge detail well reflect different colour accents.”

| | Item Code | Size (mm & Inches) | Material | Size (Inches) | | | | Fig. |
|---|---------------|--------------------|-----------|---------------|------|------|------|------|
| | | | | A | B | C | D | |
| 1 | CP.520.96.XX | 96mm (3.78") | Brass | 5.2 | 1.65 | 3.78 | 1.14 | 1 |
| 2 | CP.520.192.XX | 192mm (7.56") | Brass | 9.06 | 1.65 | 7.56 | 1.14 | 1 |
| 3 | CP.520.96.XX | 96mm (3.78") | Bronze | 5.2 | 1.65 | 3.78 | 1.14 | 1 |
| 4 | CP.520.192.XX | 192mm (7.56") | Bronze | 9.06 | 1.65 | 7.56 | 1.14 | 1 |
| 5 | CP.520.96.XX | 96mm (3.78") | Cast Iron | 5.2 | 1.65 | 3.78 | 1.14 | 1 |
| 6 | CP.520.192.XX | 192mm (7.56") | Cast Iron | 9.06 | 1.65 | 7.56 | 1.14 | 1 |

“XX” in item code denotes Finish ID.

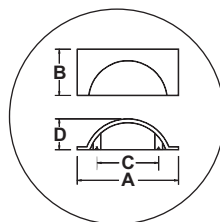

FIG. 1

This product is Supplied with M4x25mm screws.
This product is Supplied with M4x45mm break off screws.

How to Order

CP.520.96.8

CUP PULL STYLE : BEAULIEU SIZE : CC 96MM FINISH ID : 8

Beaulieu Cup Pull Finish Options

| | | | | | |
|--|--|--|--|--|--|
| Base Material : Cast Iron | | Custom Finishes (3-4 Weeks Delivery)* | | | |
|  | | | | | |
| Pewter (Finish ID:1) | | | | | |
| Base Material : Brass | | Standard Finishes (2-3 Weeks Delivery) | | | |
|       | | | | | |
| Bright Chrome (Finish ID:2) Brush Nickel (Finish ID:3) Aged Brass (Finish ID:4) Unlacquered Polished Brass (Finish ID:7U) Polished Nickel (Finish ID:8) Satin Brass (Finish ID:13) | | | | | |
| Base Material : Brass | | Custom Finishes (3-4 Weeks Delivery)* | | | |
|      | | | | | |
| Lacquered Polished Brass (Finish ID:7L) Matte Black (Finish ID:19) Graphite (Finish ID:61) Ombre (Finish ID:92) Brush Chrome (Finish ID:95) | | | | | |
| Base Material : Bronze | | Custom Finishes (3-4 Weeks Delivery)* | | | |
|    | | | | | |
| Silicon Bronze Light (Finish ID:53) Silicon Bronze Dark (Finish ID:53D) White Bronze (Finish ID:54) | | | | | |

- Custom finishes cannot be returned or refunded. We are unable to accept cancellations for custom finish order unless within 48 hours of the order being placed.
- We have uniform pricing for all non-hammered finishes listed above as long as base material and size is same.
- Contact us for customized finishes, refer pages F1, F2, F3 & F4 for finish glossary.